

An identity platform with workforce IAM for digital enterprises

ManageEngine Identity360 provides powerful capabilities such as a built-in Universal Directory, identity orchestration, SSO, MFA for apps and endpoints, role-based access control, and access insights. It helps you effortlessly scale, ensure compliance, and prioritize identity-first security, all from a centralized console.

Centralize identity management and reinforce security with our robust IAM solution.

- Leverage orchestration and smart templates to streamline user management and boost productivity.
- Secure access to cloud applications and endpoint devices with MFA to meet compliance goals and achieve Zero Trust
- Elevate user experience with hassle-free passwordless login and one-click access to all enterprise apps from a centralized console.
- Ensure scalability with a cutting-edge, cloud-powered IAM solution, leading to zero maintenance costs.

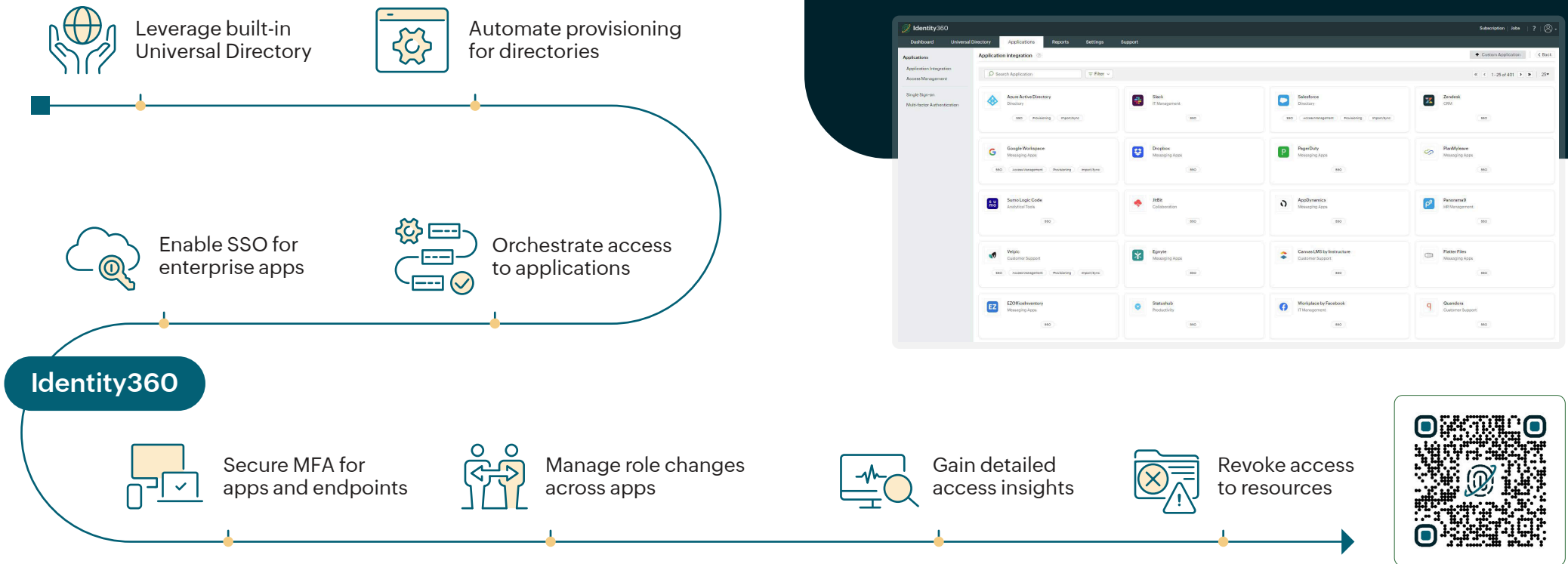



Life cycle management

Effortlessly manage user life cycles with Identity360's Universal Directory by onboarding users across integrated directories and apps, and allowing admins to centrally manage application access, delegate IT tasks, and gain insights through built-in reports.

STARTS AT

\$295

for 100 users per user



MFA and SSO

Experience highly secure, one-click access to your integrated directories and applications with Identity360's MFA-powered SSO, and facilitate seamless management by storing users in the Universal Directory and delegating routine tasks to technicians.

STARTS AT

\$195

for 100 users per user

3

Reasons to choose Identity360



Fully cloud-powered

Identity360 is entirely cloud-native, eliminating the need to worry about infrastructure costs or maintenance.



IAM on your terms

Identity360 has different components that solve various IAM challenges. Pick the components you need, and pay only for what you choose.



Directory as a service

Identity360 streamlines IT operations with its DaaS offering, a built-in Universal Directory. It centralizes user authentication, access control, and identity life cycle management.



Benefits

Streamlined user management

Utilize a centralized console for managing user identities and access permissions across various platforms.



Improved security

Boost security by ensuring only authorized users can access certain resources and reduce the risk of data breaches.

Identity360

Enhanced visibility

Achieve regulatory compliance standards by consistently monitoring user actions with detailed reports.



Increased productivity

Ensure users have access to resources from day one by orchestrating user provisioning and access.